

Tower Grove, Leigh, WN7 2TZ
£69,950



BALMER & CO in LEIGH are delighted to offer for sale this one bedroom, first floor apartment in Leigh. Offered with NO ONWARD CHAIN this property comprises in brief of entrance hallway, large living room, fitted kitchen/dining room, master bedroom, with three piece bathroom completing the accommodation on offer. Access to the property is provided by a side door with a staircase leading up. Externally there are communal gardens to the front and rear. Early viewings highly recommended, all enquiries welcome.

Floor Plan

1ST FLOOR
387 sq.ft. (35.9 sq.m.) approx.

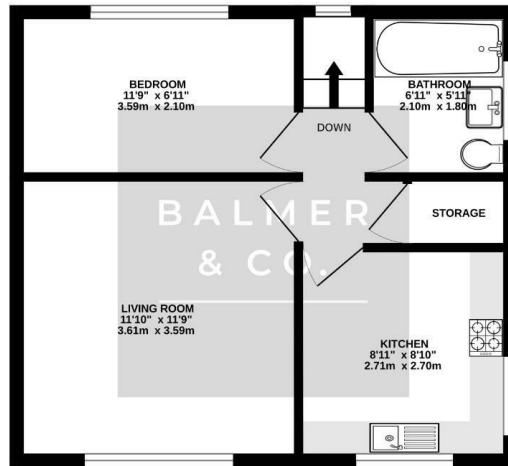

TOTAL FLOOR AREA: 387 sq.ft. (35.9 sq.m.) approx.
Whilst every attempt has been made to ensure the accuracy of the floorplan contained herein, measurements of plots, buildings, areas and any other facts are approximate and no responsibility is taken for any errors, omissions or misstatements. This plan is for guidance purposes only and should not be used as the sole basis for any prospective purchase. The services, fixtures and appliances shown here are not intended and to guarantee as to the quality or efficiency of the same.
Mark van Meerigen COICE

Area Map

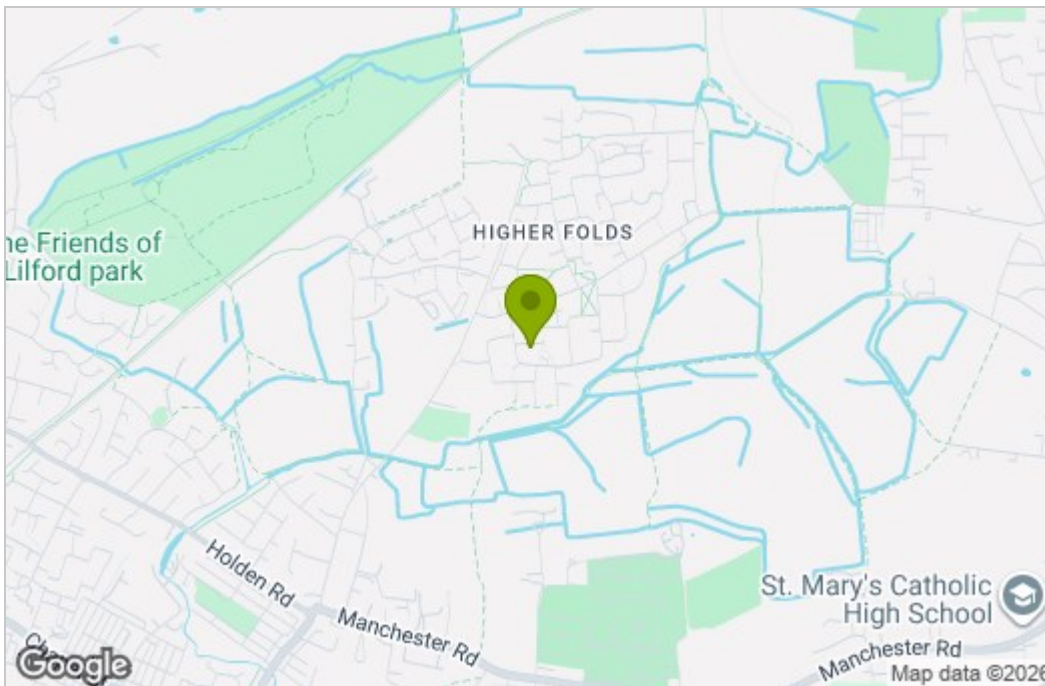

Energy Efficiency Graph

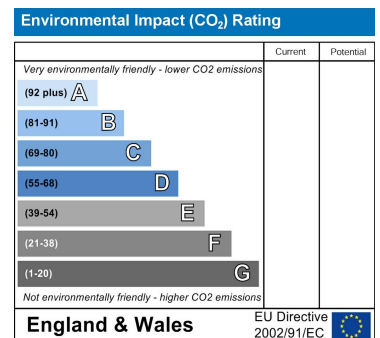
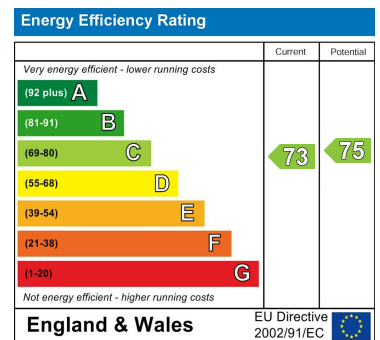

These particulars, whilst believed to be accurate are set out as a general outline only for guidance and do not constitute any part of an offer or contract. Intending purchasers should not rely on them as statements of representation of fact, but must satisfy themselves by inspection or otherwise as to their accuracy. No person in this firm's employment has the authority to make or give any representation or warranty in respect of the property.